



ENTRANCE VIEW

INDEX

|      |                             |
|------|-----------------------------|
| A0   | COVER PAGE                  |
| A1   | AXONOMETRIC VIEW            |
| A2   | MULTIPURPOSE VIEW           |
| A3   | NEW SITE PLAN               |
| A3.1 | ALTERNATIVE SITE PLANS      |
| A4   | PARTIAL BUILDING PLAN       |
| A5   | PARTIAL BUILDING PLAN       |
| A6   | ENLARGED FLOOR PLAN         |
| A7   | ENLARGED FLOOR PLAN         |
| A8   | ENLARGED FLOOR PLAN         |
| A9   | ENLARGED FLOOR PLAN         |
| A10  | ENLARGED FLOOR PLAN         |
| A11  | ENLARGED FLOOR PLAN         |
| A12  | QUAD VIEW                   |
| A13  | MASS TIMBER CONSTRUCTION    |
| A14  | TIMBERQUEST EXAMPLE PROJECT |





[Click to take tour  
of Sacred Heart  
School Interiors](#)









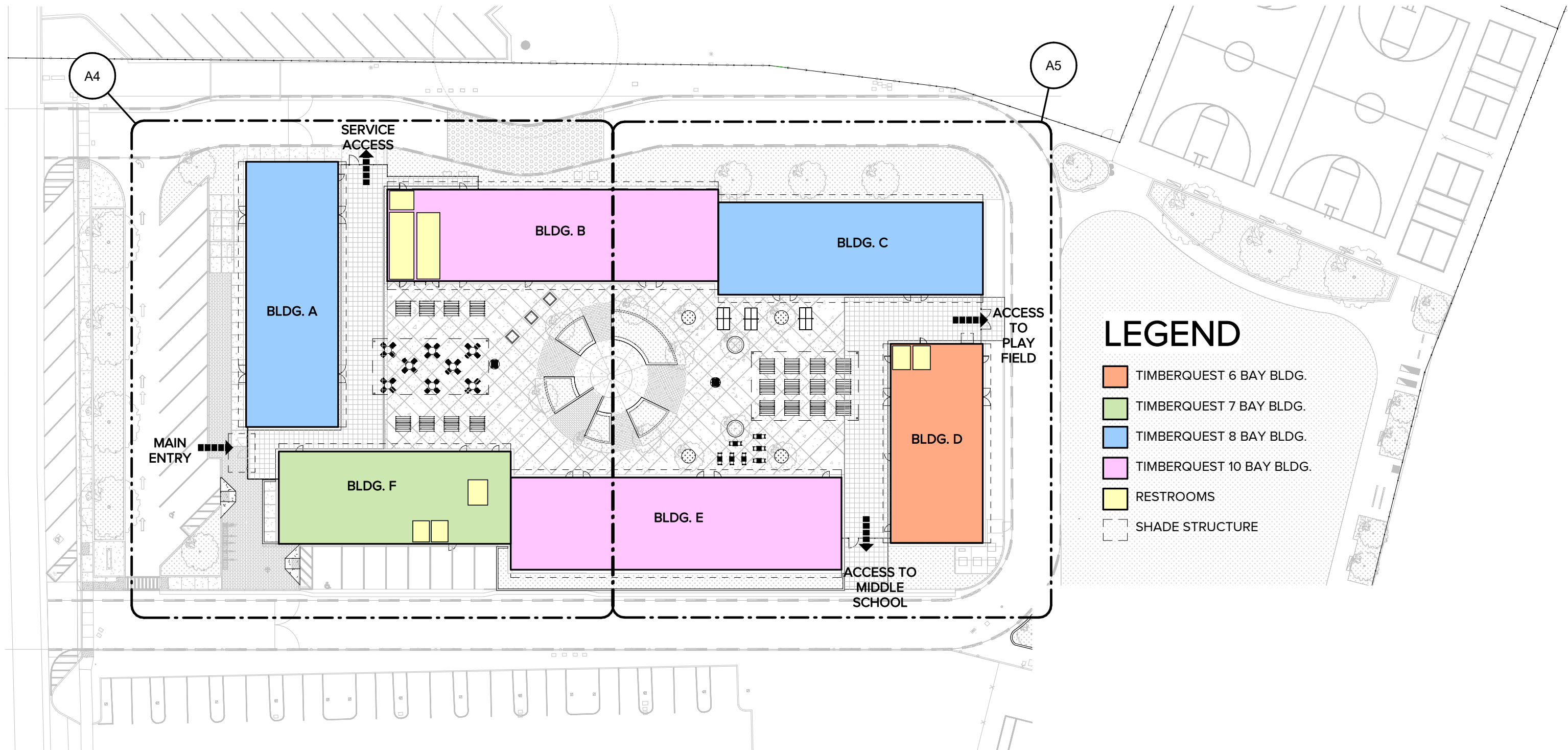

## LEGEND

- TIMBERQUEST 6 BAY BLDG.
- TIMBERQUEST 7 BAY BLDG.
- TIMBERQUEST 8 BAY BLDG.
- TIMBERQUEST 10 BAY BLDG.
- RESTROOMS
- SHADE STRUCTURE

**SITE PLAN**  
SCALE: 1" = 40'-0"

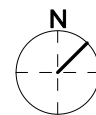



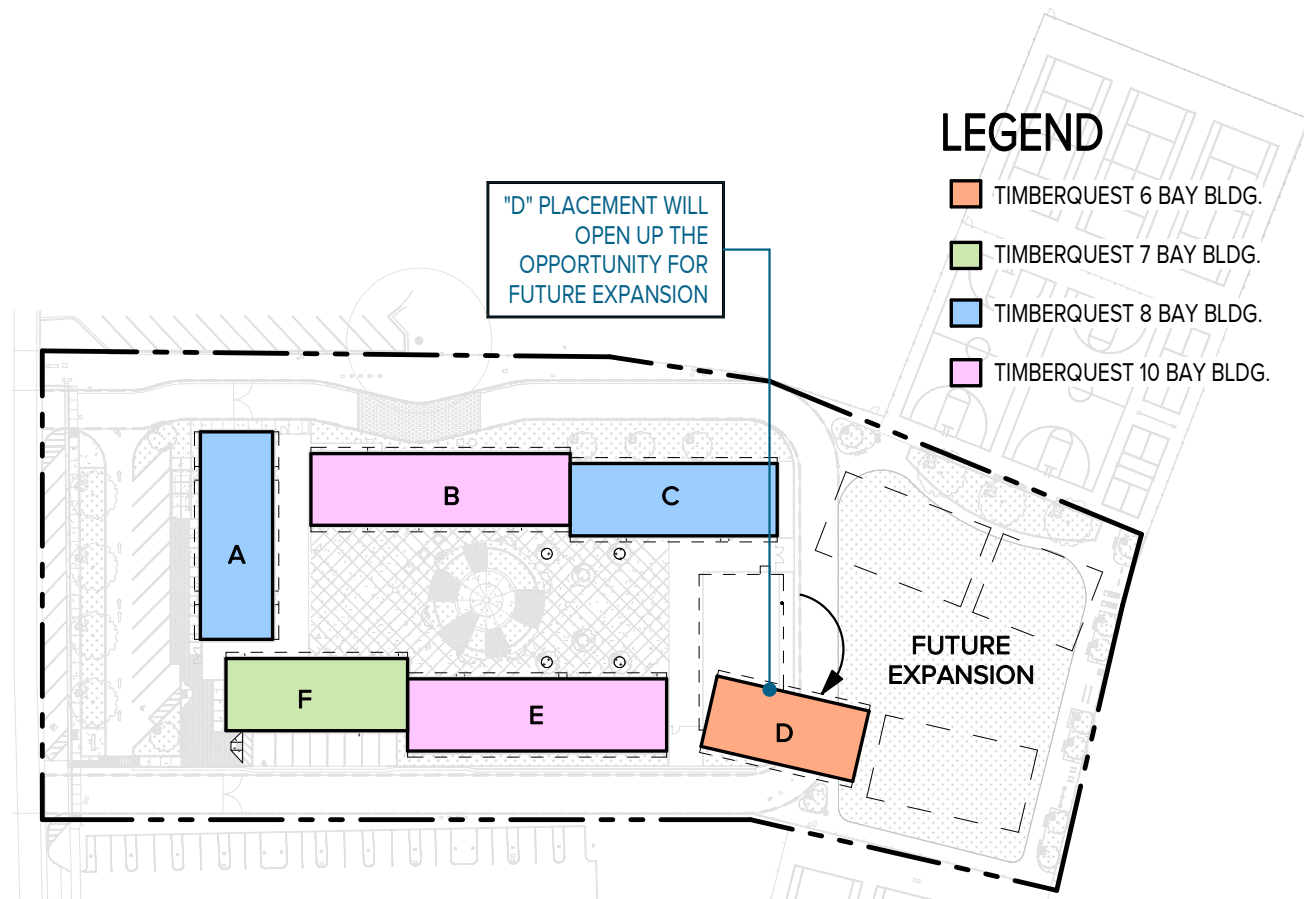

### ALT. PLAN #1 - FUTURE EXPANSION

SCALE: 1" = 100'-0"

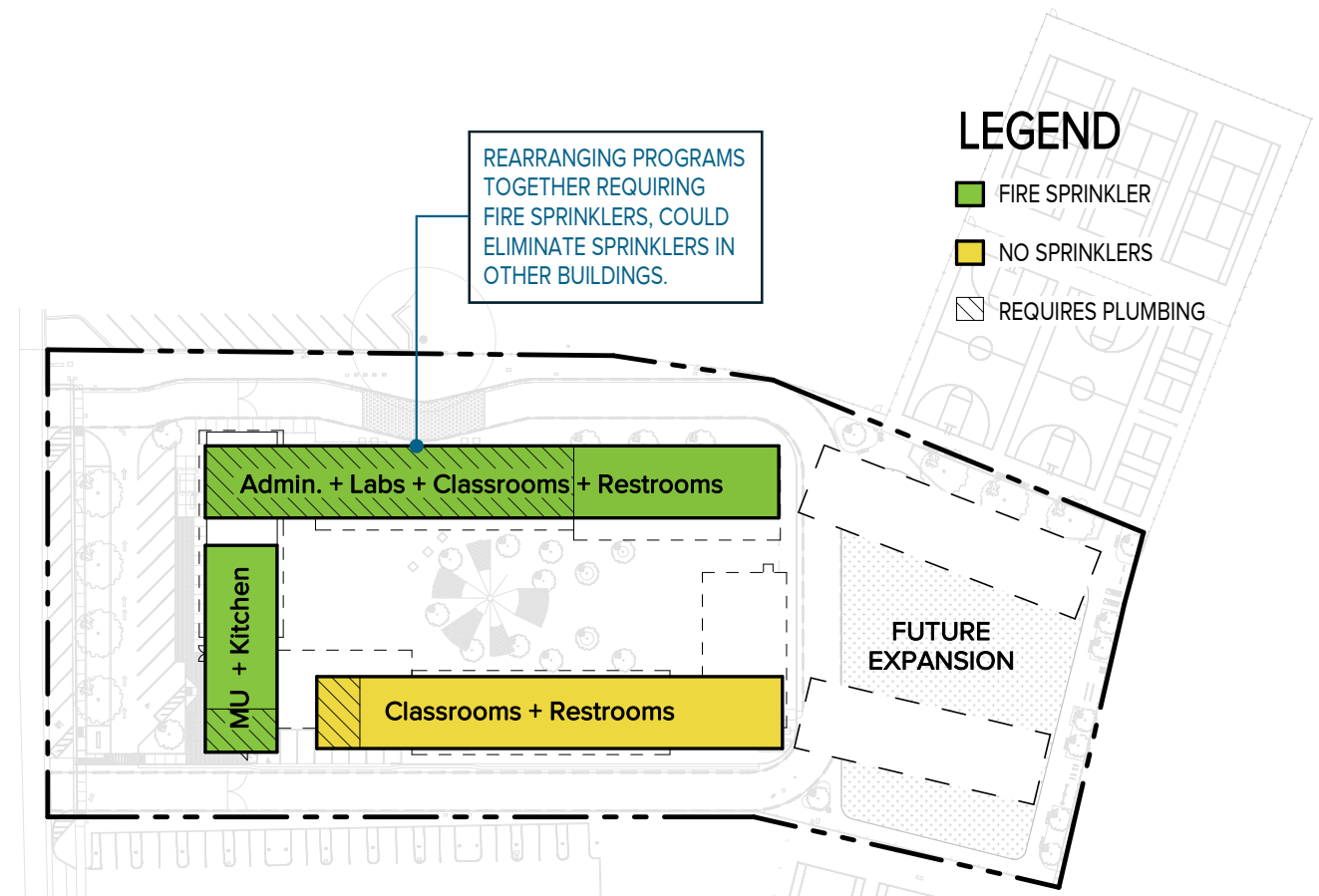
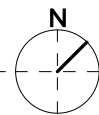

### ALT. PLAN #2 - PLUMBING & FIRE SPRINKLER EFFICIENCY

SCALE: 1" = 100'-0"

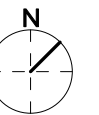



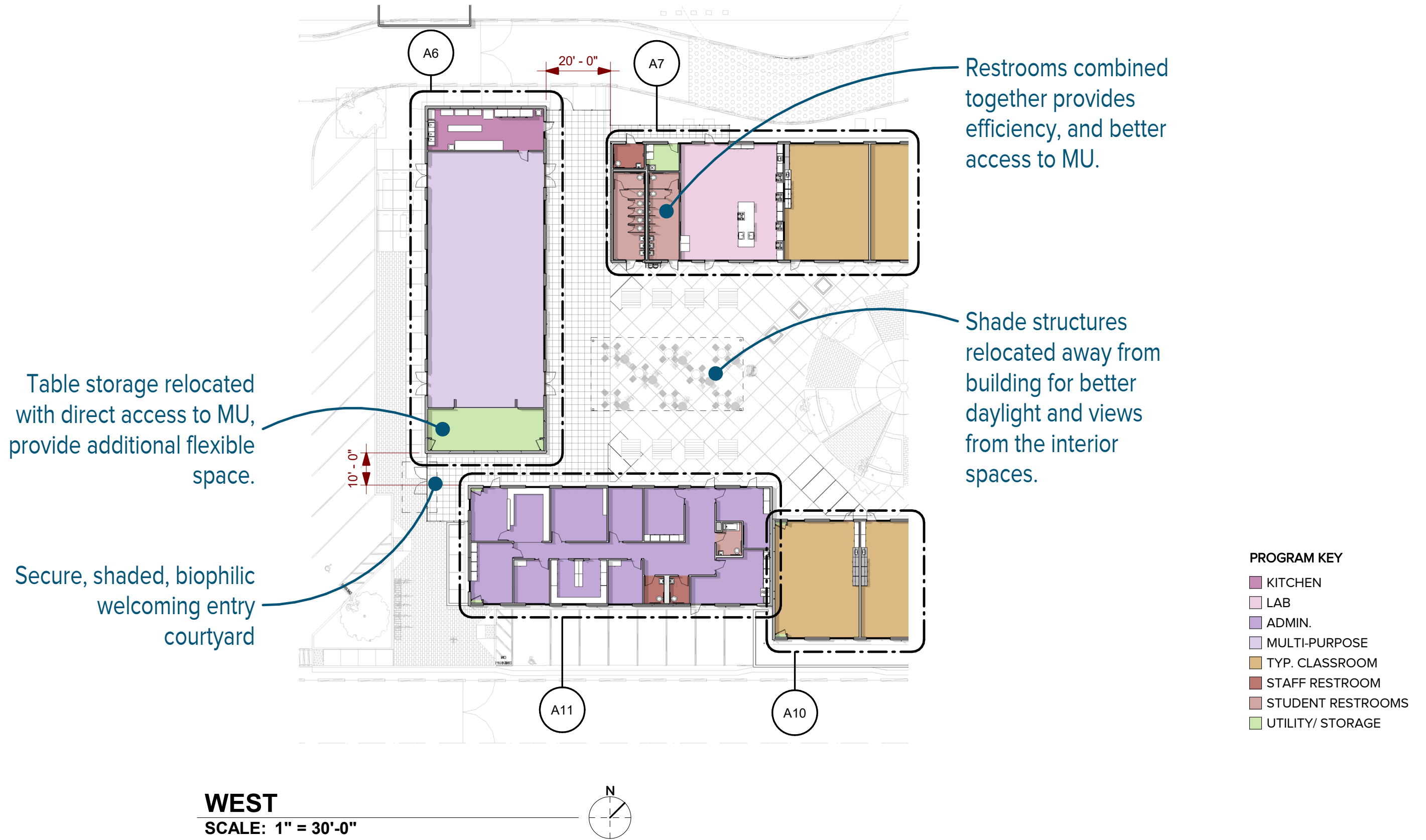



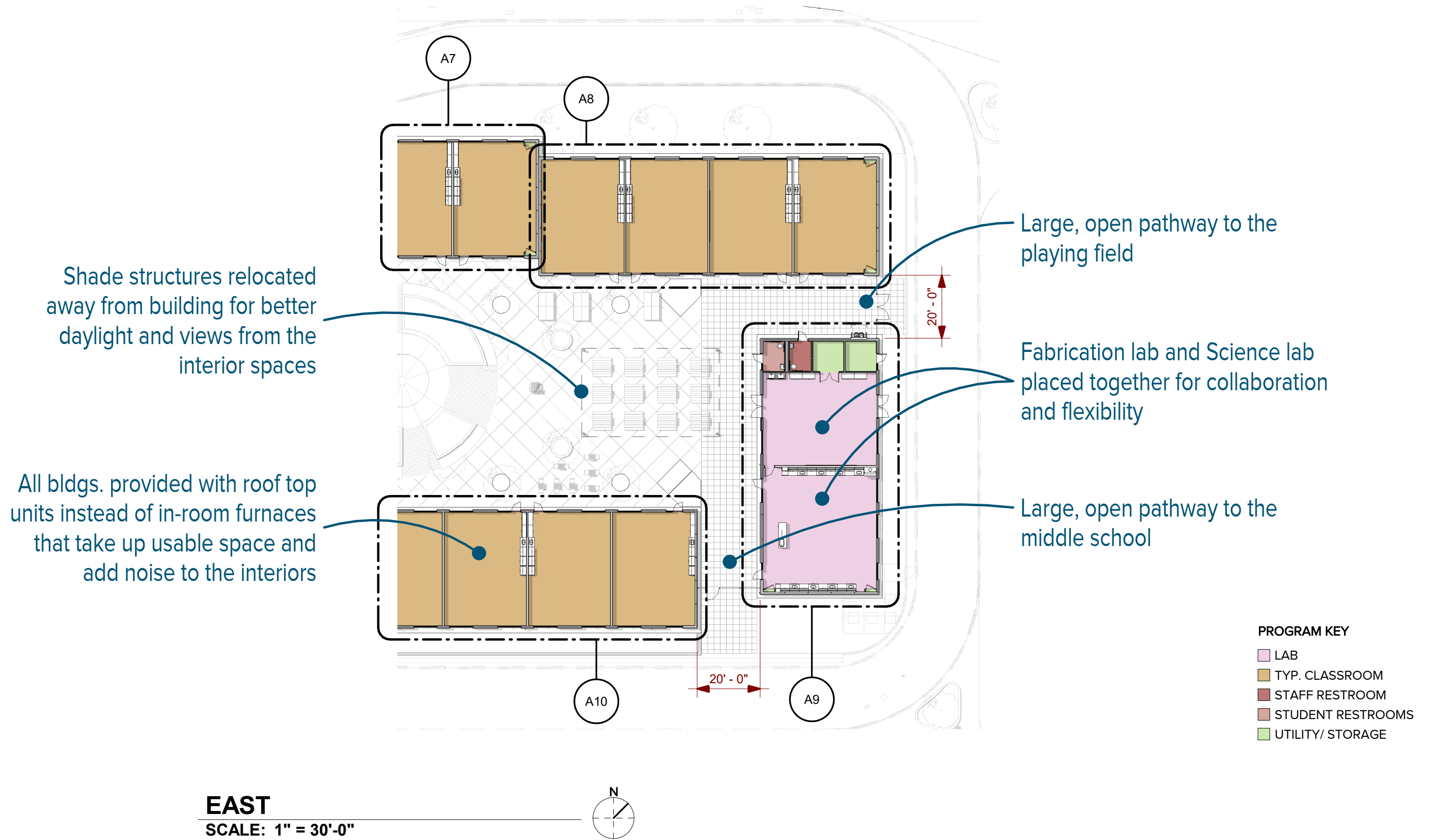



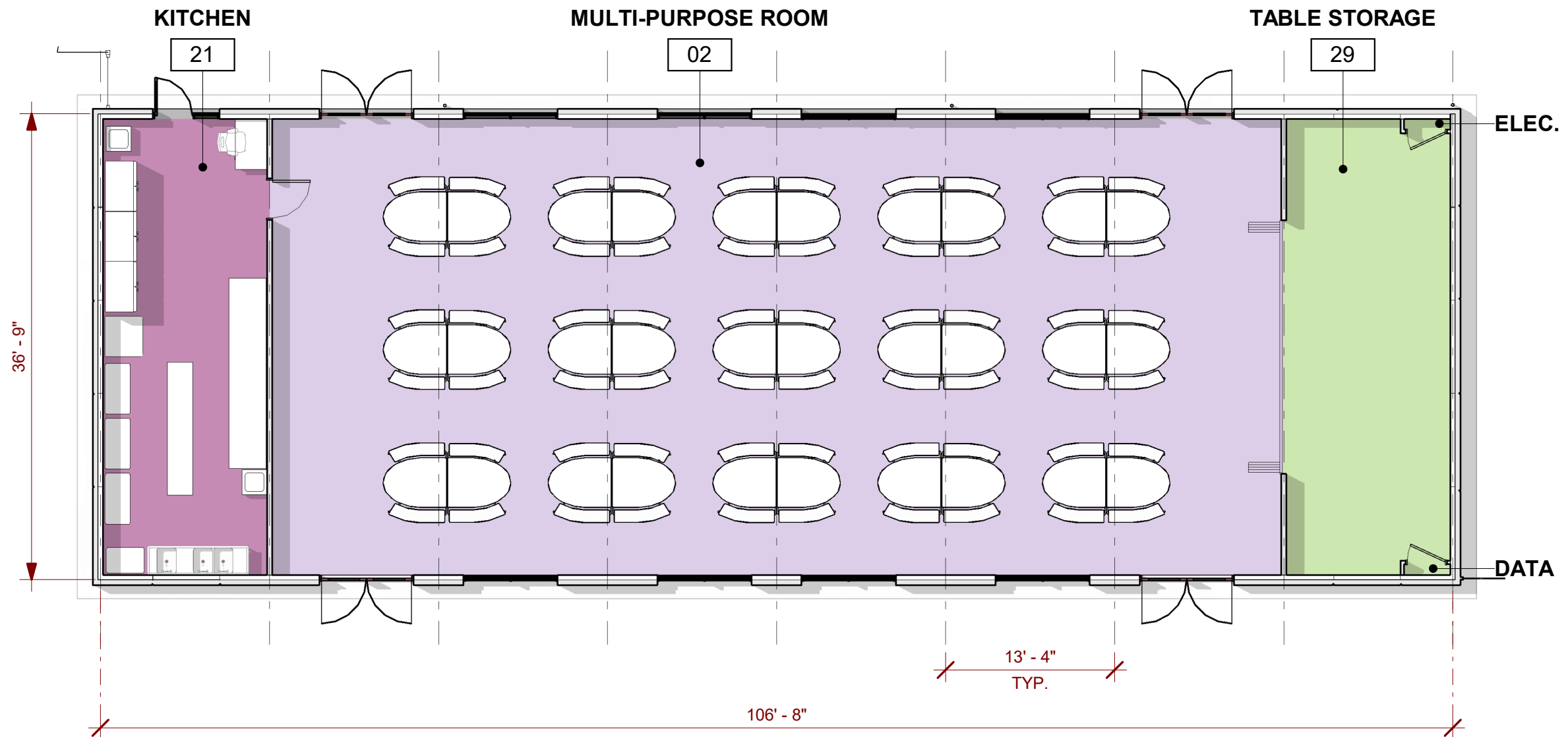

**BUILDING A**  
SCALE: 1" = 10'-0"

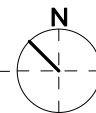



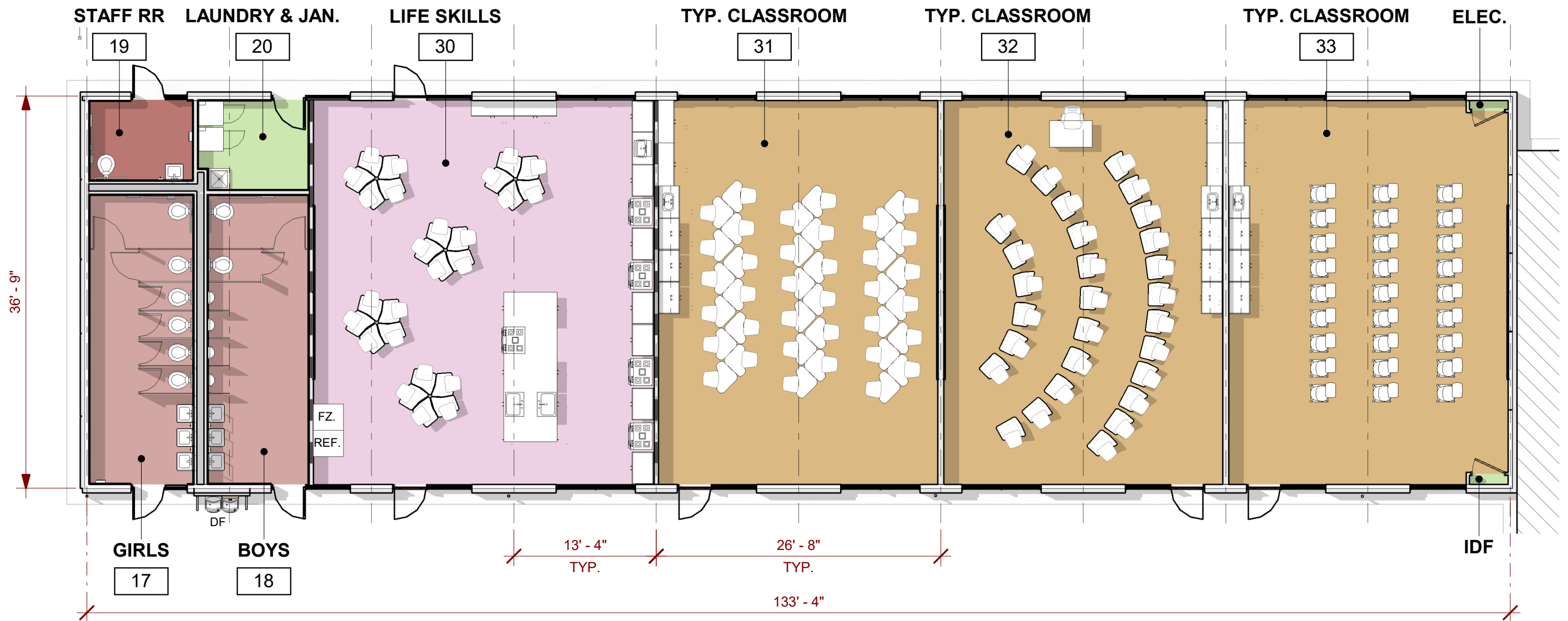

**BUILDING B**  
SCALE: 1" = 10'-0"

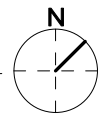



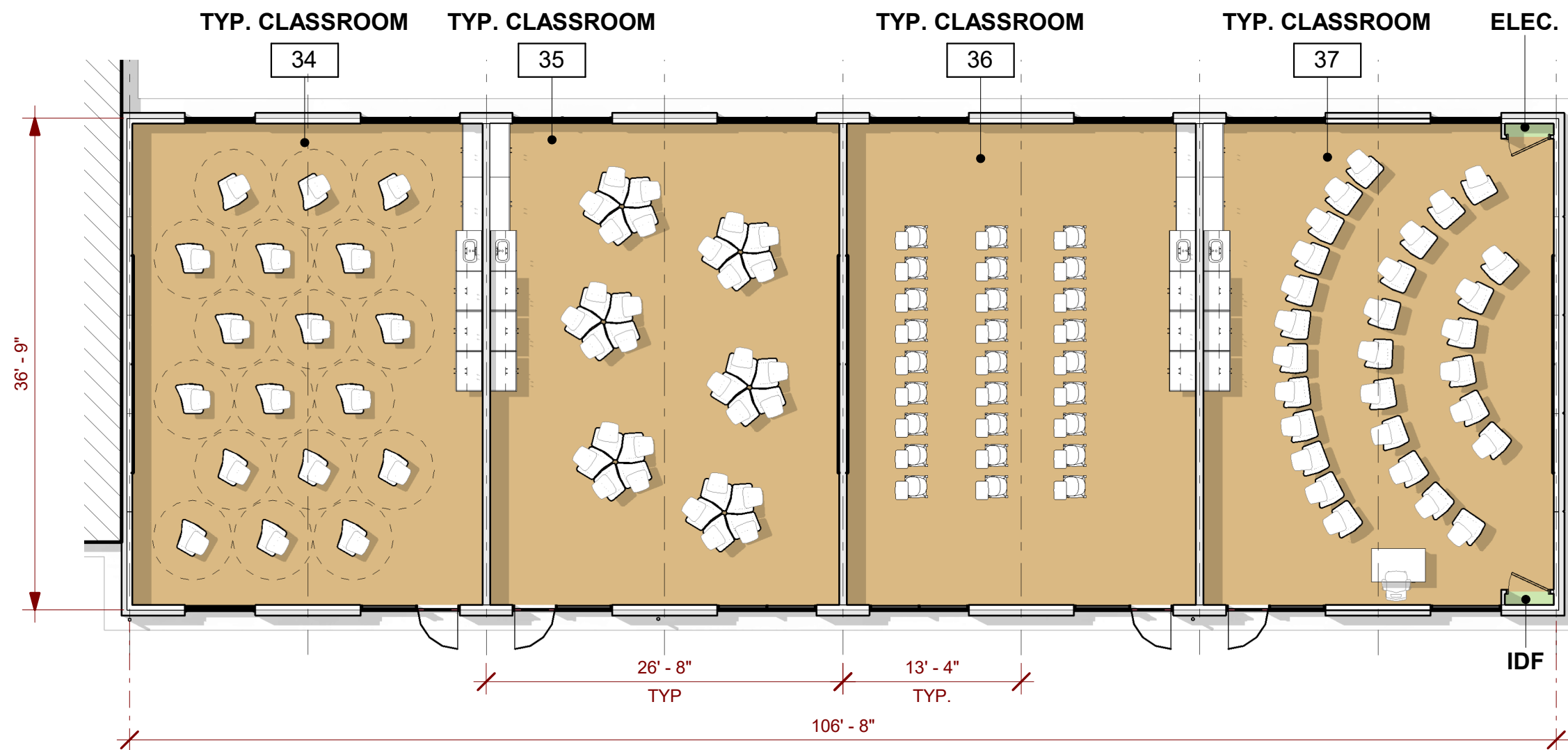

**BUILDING C**  
SCALE: 1" = 10'-0"

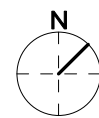



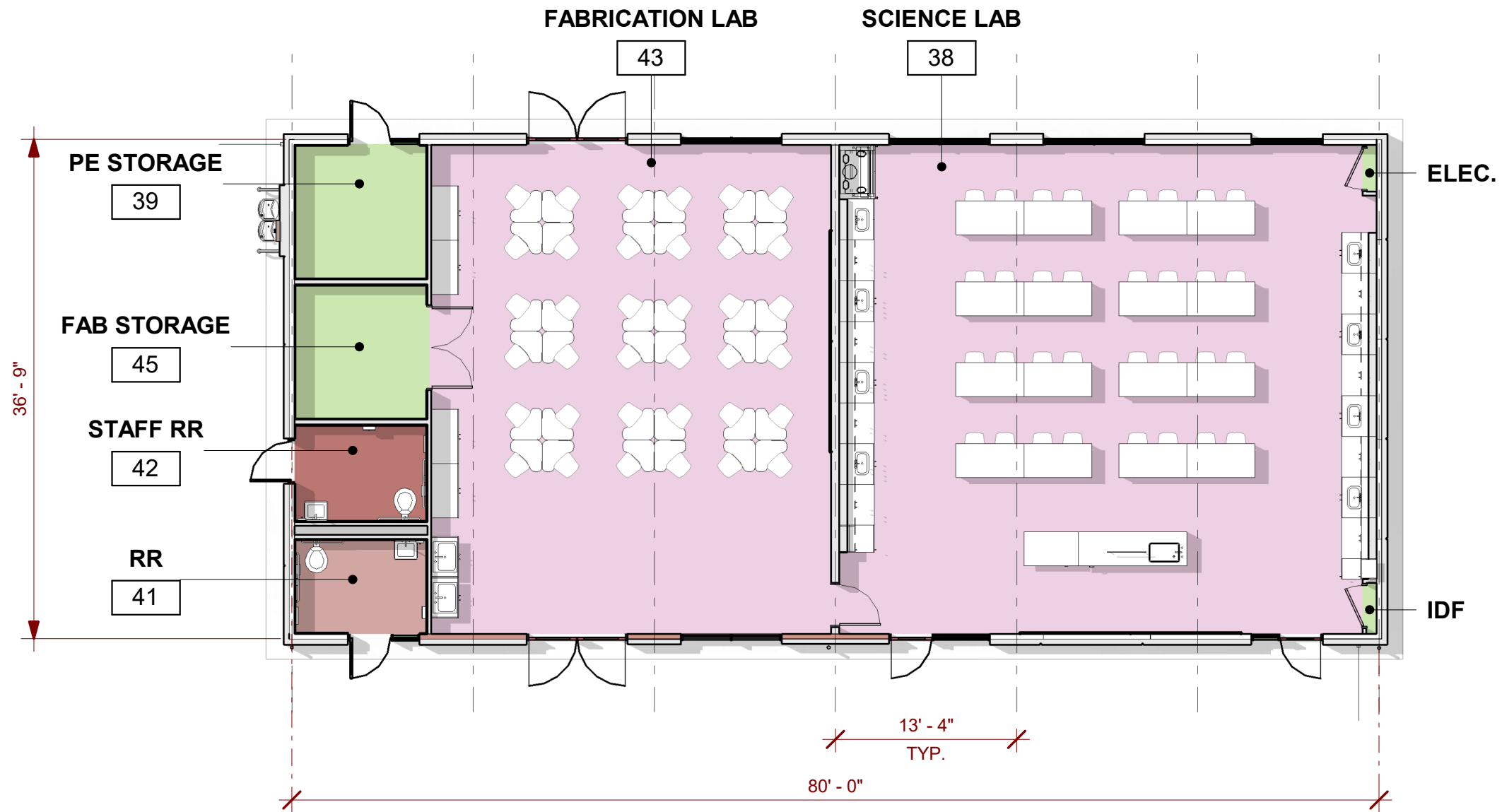

**BUILDING D**  
SCALE: 1" = 10'-0"

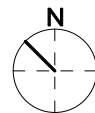



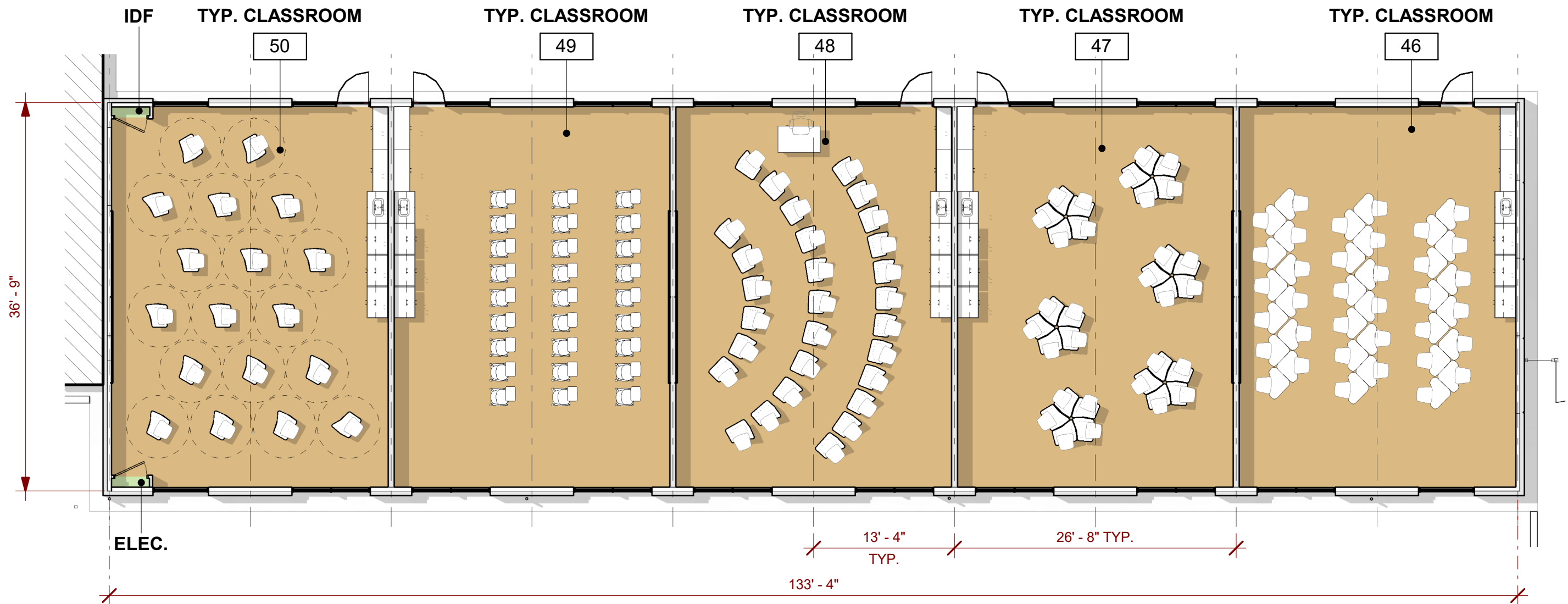

**BUILDING E**  
 SCALE: 1" = 10'-0"



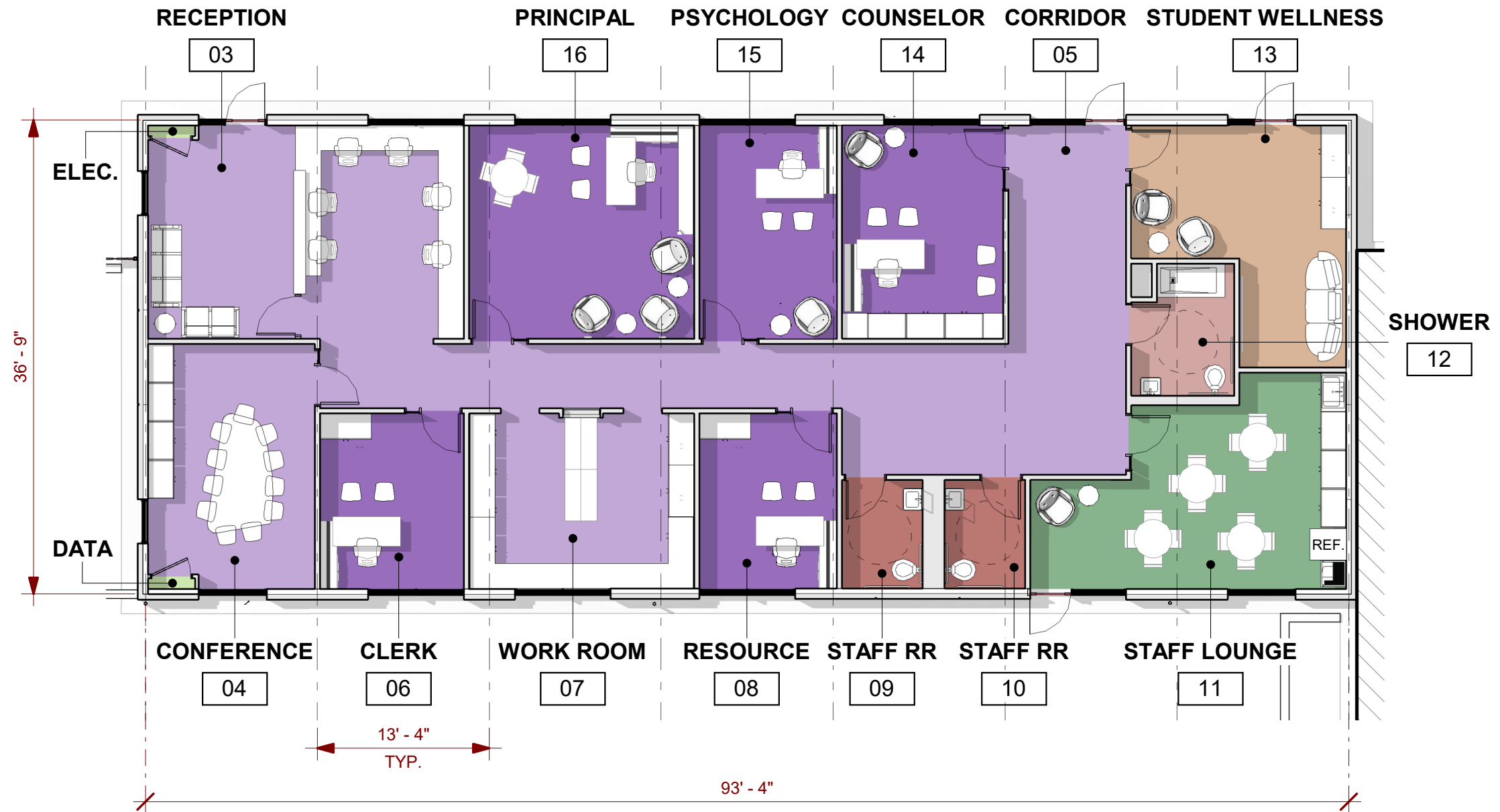

**BUILDING F**  
SCALE: 1" = 10'-0"

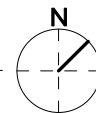







WHAT IS MASS TIMBER / CROSS LAMINATED TIMBER (CLT)?

- Manufactured out of small diameter timber
- Assembled into large format structural slab
- Strong, yet lightweight
- Environment benefits
- Allowed by Building codes



CARBON STORY FOR LINCOLN HIGH SCHOOL

- V** Volume of wood products used:  
12,120 cubic feet of mass timber
- T** U.S. and Canadian forests grow this  
much wood in: 1 minute
- C** Carbon stored in the wood:  
306 metric tons of CO<sub>2</sub>
- CO** Avoided greenhouse gas emissions:  
118 metric tons of CO<sub>2</sub>
- ✓** TOTAL POTENTIAL CARBON BENEFIT:  
424 metric tons of CO<sub>2</sub>

- EQUIVALENT TO:**
- 90 cars off the road for a year
  - Energy to operate 45 homes for a year

Source: US EPA

Estimated by the Wood Carbon Calculator for Buildings, based on research by Sarthre, R. and J. O'Connor, 2010, A Synthesis of Research on Wood Products and Greenhouse Gas Impacts, FPInnovations. Note: CO<sub>2</sub> on this chart refers to CO<sub>2</sub> equivalent.



Exposed interiors are beautiful, warm and natural



Precision machined, provides high level of construction quality

[Click to view installation of CLT panels](#)







SACRED HEART SCHOOL, ATHERTON CA

Click to take tour  
of Sacred Heart  
School Exteriors

